

ELIZABETH STREET RESIDENCE

煦阳之绘

设计 / Tim Dorrington 摄影 / Emma-Jane Hetherington 编译 / 范嘉苑 美编 / 彭旭华

项目地址 新西兰
项目面积 232m²
设计单位 Dorrington Atcheson Architects



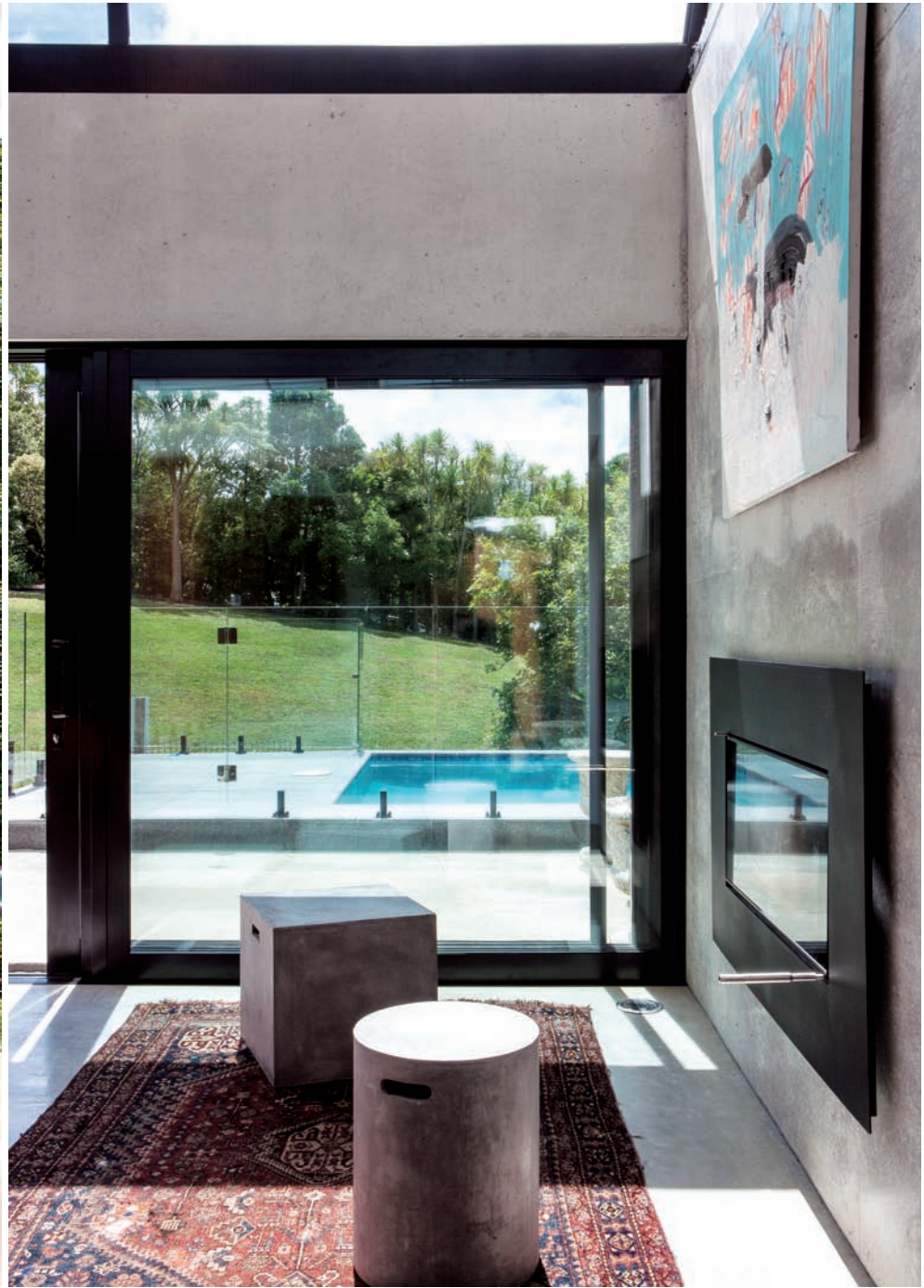

Tim Dorrington
新西兰Dorrington Atcheson Architects
创始人兼主设计师

这座住宅位于历史悠久的费里曼海湾郊区，它以混凝土、钢铁和玻璃作为主要建筑材料，混凝土外墙上的水平纹路与护墙板的垂直线条相互呼应，形成了有趣的反差感。荷兰风格的山形屋顶覆盖了一层钢板，这层略呈山形的二层空间被设计成宜居的“阁楼”，不禁让人想起了殖民时代风格的屋顶窗。

整座房子共有两层居住空间，首层横跨了20米的长度，起居室直接面向庭院，和煦的阳光从大面玻璃透进屋里，加上双层高的空间高度，让整个客厅看起来宽敞明亮。客厅的家具及配饰以鲜艳的色彩为主，例如橙色的沙发、茶几以及红色的地毯都洋溢着热情活泼的气息，佐以多幅色彩丰富的绘画作品，让整个客厅充满生气。富有工业色彩的混凝土墙面与嵌入起居室的弧形雪松木板相搭配，强烈的质感及色彩反差让整个客厅空间看起来极具层次感，而雪松板背后则是车库的所在位置。厨房与餐厅共处一个空间，此处以灰、白、黑为主要色彩，勾勒出庄重却不失时尚的空间画面。大理石的餐桌显露出高贵奢华之感，而橙色的餐椅则与客厅的色调相得

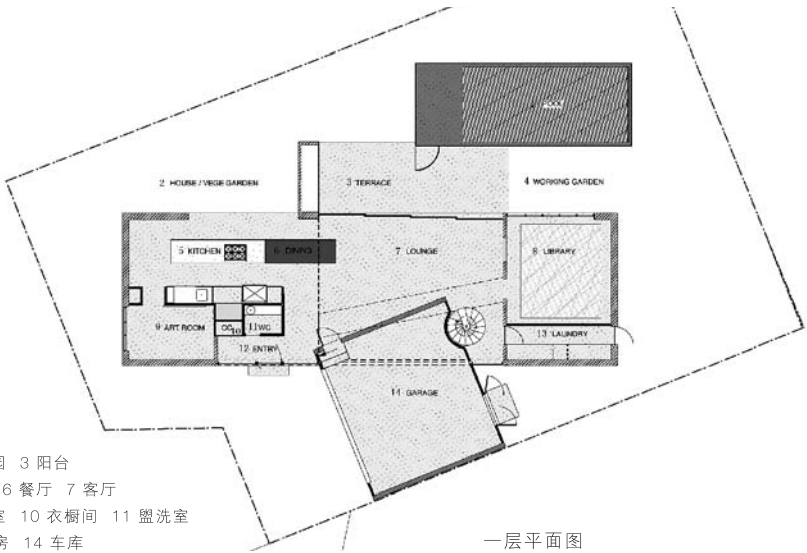



益彰。一面带有褪色效果的刨花板柜墙将衣橱间及盥洗室隐于其后，较为低矮的天花板则营造出一种隐私感，有助于让就餐者之间更加亲近地交流。

通过一条螺旋式的混凝土楼梯能上至二楼，这里的空间结构让人大感惊喜。一条呈斜线的架桥连通了主卧及儿童房。这层最具特色的设计就是色彩活泼跳动的“管状”浴室，多个不同的色彩面营造出极富趣味性的视觉效果。最终，这栋住宅完美地达成了业主的诉求——它将开阔性和包围感出人意料地结合在一起，通过原始的材料语言演绎出一座富有现代感的宅邸。

This building in the heritage suburb of Freeman's Bay is a composition of concrete, steel and glass that gives a handshake to the past. Horizontal texture on the precast concrete walls echoes the linearity of weatherboards. The roof, styled as a Dutch gable and clad in steel, is conceived as a habitable "attic" space that makes reference to the dormers of colonial times.

The house offers two levels for living. At its base, an elongated footprint spans 20 meters to lend a sense of generosity that is elevated by the double-height void above the living zone. The furniture and decoration in the living room mainly use showy colors, such as the orange sofa and red carpet, with the colorful paintings, making this space look gorgeous. The industrial palette meets its counterpoint in a cedar-wrapped insertion that curves into the living room but houses the garage. The kitchen shares a same space with the dining room while the grey, white and black colors picture an elegant and fashionable space. The marble dining table exposes a luxurious feeling while the orange dining chairs echo the color of furniture in the living room. A wall of cabinetry in black-stained particle board continues to enclose a powder room and a coat cupboard, while lowered ceilings define an intimate feeling.



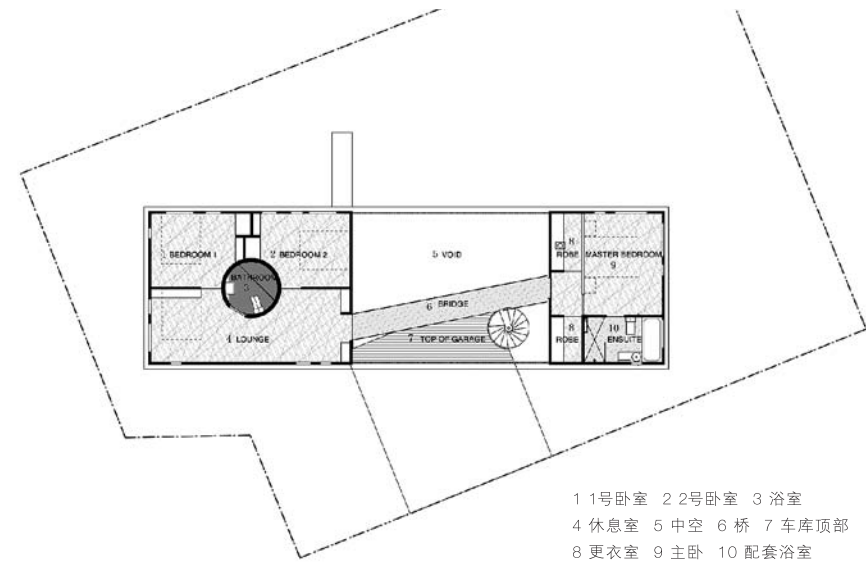

二层平面图

The surprising architectural geometry of the home is picked up in a spiral stair of concrete that leads to the upper level. Here, a diagonal bridge is a link between the adults' and kids' bedrooms. A mischievous tube in colors encases the bathroom here, its faceted shape providing further visual interest.

This family home fits the owners' brief for an interpretation of contemporary living that celebrates the raw expression of materials with an unexpected combination of openness and enclosure. **M**

